



B-Right Real Estate Ltd. Project Status November 2022



B-Right

Real Estate Limited
Building Real Value Homes

INDEX

- [On Going Projects](#)
- [Upcoming Projects](#)
- [Map](#)
- [Disclaimer](#)



B-Right
Real Estate Limited
Building Real Value Homes





NIRVANA (MALAD EAST) **SIDDHIVINAYAK DEVELOPERS KURAR**

- **>1,00,000 sq. ft. of Saleable Area**
- **Completed 1st Slab for Rehab Building, Columns above Plinth Casted for Sale Building Wing A, Plinth For B wing in Progress.**
- **Received Full C.C. for Rehab Building**
- **Received C.C. till 13th Floor Slab for Sale Building**



SHRISHTI (KHAR WEST)

D.M. PARTNER WITH AUM CREATORS

- Approximately 12,000 sq. ft. of Rera Carpet Area.
- Completed 10 Slabs.
- Application for further full C. C. in progress.
- Completed Basement Plaster and 80% Waterproofing Work.
- Blockwork and Electric Piping Completed till 7th Floor.
- Plaster work complete till 6th Floor.



B-Right
Real Estate Limited
Building Real Value Homes



SRUSHTI ENCLAVE (CHEMBUR)

D.M. PARTNER WITH GADKARI BUILDERS AND ASSOCIATES

- Completed 13 Slabs, working on 14th.
- Column Casted For 14th Floor Slab.
- Full C.C. in process.
- All work Completed till 8th Floor.
- M.H.A.D.A. Project.

Upcoming Projects



- **Damyanti Villa (GOREGAON WEST)**
DARC REALTY
 - Vacant Plot.
 - Approvals in process.
 - Approximately 10,000 sq. ft. of Rera Carpet Area.
 - Redevelopment Project.
- **Vasant Harmony (Andheri East)**
HARMONY LIFESTYLE PROJECTS
 - >30,000 sq. ft. of Rera Carpet Area.
 - C.F.O. NOC applied.
 - C.C. application process starting soon.
 - Commercial Redevelopment Project.
- **Khot Dongri SRA Project (MALAD EAST)**
B-RIGHT HOUSECON LLP
 - Project to start in 6 months subject to approvals.
 - > 4 Lakhs sq. ft. of Rera Carpet Area
 - C.C. Received.
 - Social Impact Project.

Upcoming Projects



- **Veer Sambhaji Nagar SRA Project (MULUND WEST)**
FAREWELL REAL ESTATE PVT. LTD.
 - M.O.U. Signed in August 2022.
 - Rera Carpet Area of > 6,00,000 sq. ft.
 - Social Impact Project.
 - Partially vacated plot.
- **Shivaji Nagar SRA Project (BORIVALI WEST)**
D.M. REALTORS
 - All N.O.C.'s Received.
 - Approvals in Process.
 - Rera Carpet Area of > 5,00,000 sq. ft.
 - Social Impact Project.
- **Mahankali Nagar SRA (BORIVALI EAST)**
B-RIGHT REALESTATE LTD. / Associates
 - Project to start in 6 months subject to approvals.
 - > 4 Lakhs sq. ft. of Rera Carpet Area.
 - Social Impact Project.

Upcoming Projects



- **Ambika Nagar SRA Project (JOGESHWARI EAST)**
PARTH CONSTRUCTION
 - >5 Lakhs sq. ft. of Rera Carpet Area.
 - L.O.I., I.O.D., C.C. conversion in process.
 - Vacating in progress, more then 100 tenants vacated.
 - Social Impact Project.
- **Patel Estate (KANDIVALI EAST)**
B-RIGHT REALESTATE LTD. / Associates
 - Rera Carpet Area of > 75,000 sq. ft.
 - M.O.U. Signed – Conveyance work in progress
 - Next to Kandivali Station.



PROJECT	LOCATION	PLOT AREA SQ. M. (APPROX)	EXECUTION AREA SQ.FT. (APPROX) IN LAKHS
ONGOING			
NIRVANA	MALAD EAST	2660	1
SHRUSTI	KHAR WEST	550	1.5
SRISHTI ENCLAVE	CHEMBUR	750	0.32
UPCOMING			
KHOT DONGRI SRA	MALAD EAST	12000	4
SHIVAJI NAGAR SRA	BORIVALI WEST	15000	5
AMBIKA NAGAR SRA	JOGESHWARI EAST	15000	5
MAHAKALI NAGAR SRA	BORIVALI EAST	12600	4
VASANT HARMONY	ANDHERI EAST	1550	0.3
VEER SAMBHAJI NAGAR SRA	MULUND	18000	6
PATEL ESTATE	KANDIVALI EAST	2000	0.75
DAMYANTI VILLA	GOREGAON WEST	750	0.1
TOTAL		80860	29.5

INVENTORY OF ONGOING PROJECTS UPTO 30TH SEPTEMBER 2022



B-Right
Real Estate Limited
Building Real Value Homes

PROJECT	SOLD UNITS	UNSOLD UNITS	TOTAL	PAYMENTS RECEIVED	RECEIVABLES	TOTAL SOLD INVENTORY
NIRVANA	44	160	204	4.74	22.72	27.46
SHRUSHTI	2	3	5	5.5	4.58	10.08
SRISHTI ENCLAVE	0	8	8	—	—	—
TOTAL	55	194	217	10.24	27.3	37.54

- DATA AS ON 30TH SEPTEMBER 2022
- ** All amounts are in Crores.

PROJECTS

AMBIKA NAGAR SRA, JOGESHWARI-E

SHIVAJI NAGAR SRA BORIVALI-W

KHOT DONGRI SRA MALAD-E

NIRVANA MALAD-E

SHRISHTI KHAR

SRUSHTI ENCLAVE CHEMBUR

VASANT HARMONY ANDHERI-E

DAMYANTI VILLA GOREGAON

PATEL ESTATE KANDIVALI

VEER SAMBHAJI SRA CHS, MULUND

MAHAKALI NAGAR SRA BORIVALI-E



B-Right
Real Estate Limited
Building Real Value Homes

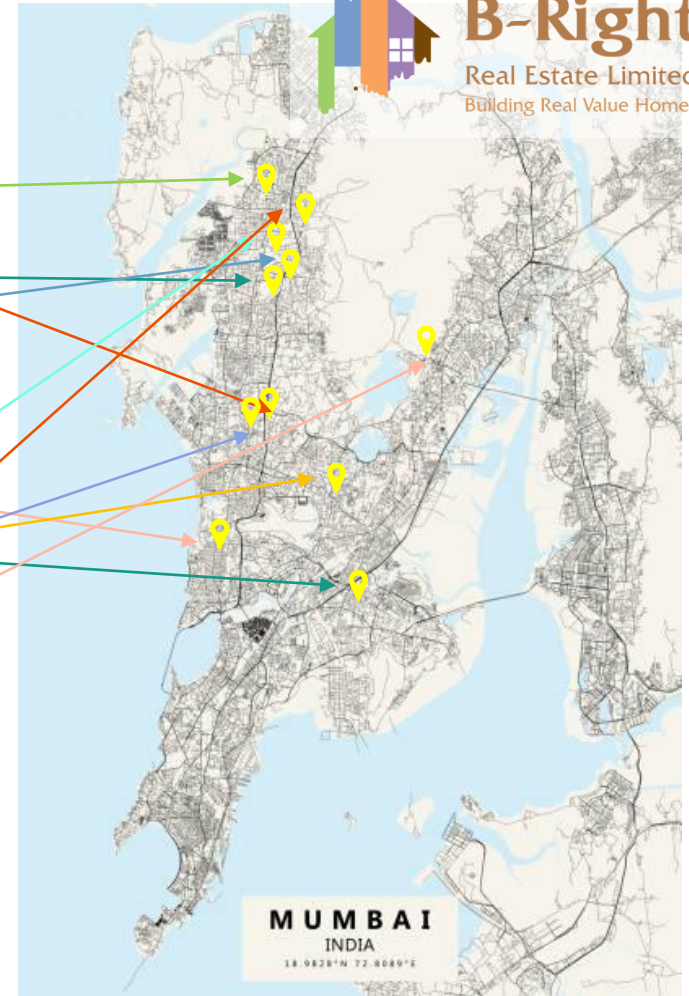

Disclaimer



B-Right
Real Estate Limited
Building Real Value Homes

- ▶ The information contained in this presentation is provided to you by B-Right Group, together with its subsidiaries and joint ventures (“the Group”) solely for your reference and for information purposes only. This presentation is highly confidential and is being given solely for your information and your use and may not be retained by you or copied by you, reproduced or redistributed to any other person in any manner whatsoever, without the prior written consent of the Group. Any unauthorized use, disclosure or public dissemination of the information contained herein is strictly prohibited.
- ▶ This presentation does not purport to be a complete description of the markets’ conditions or developments referred to herein. This presentation is for private circulation only and does not constitute a statement in lieu of an investment offer and hence, it should not be construed as an offer or a solicitation of any offer or invitation to purchase, subscribe or sell ownership in the Group.
- ▶ This presentation has been prepared by the Group based on information and data which the Group considers reliable, but the Group makes no representation or warranty, express or implied, whatsoever, and no reliance shall be placed on, the truth, accuracy, completeness, fairness and reasonableness of the contents of this presentation. This presentation may not be all inclusive and may not contain all of the information that you may consider material. Any liability in respect of the contents of, or any omission from, this presentation is expressly excluded.
- ▶ Certain matters discussed in this presentation may contain statements regarding the Group’s market opportunity and business prospects that are individually and collectively forward-looking statements. Such forward-looking statements are not guarantees of future performance and are subject to known and unknown risks, uncertainties and assumptions that are difficult to predict. These risks and uncertainties include, but are not limited to, the performance of the Indian economy and of the economies of various international markets, the performance of the industry in India and world-wide, competition, the Group’s ability to successfully implement its strategy, the Group’s future levels of growth and expansion, technological implementation, changes and advancements, changes in revenue, income or cash flows, the Group’s market preferences and its exposure to market risks, as well as other risks. The Group’s actual results, levels of activity, performance or achievements could differ materially and adversely from results expressed in or implied by this presentation. The Group assumes no obligation to update any forward-looking information contained in this presentation.

TODDLERS PLAY AREA

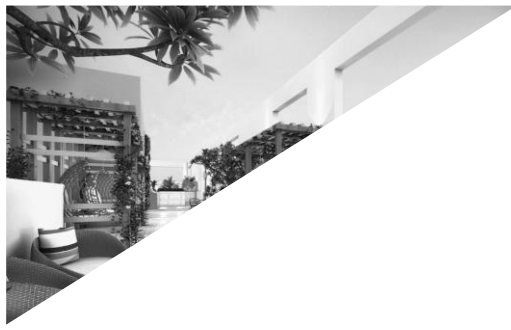
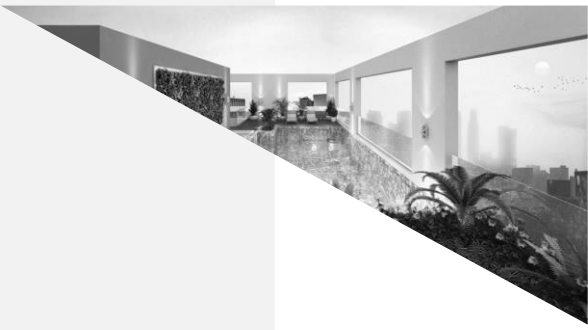

B-Right

Real Estate Limited
Building Real Value Homes

THANK YOU

